



## 正齒輪 M0.8型

### SPUR GEARS <M0.8>

	U圓孔(aperture)	T圓孔(aperture)+攻牙(TAP)	TG NEWS JIS KEY WAY+TAP TG 新JIS鍵槽+攻牙	TYPE	Material	Treatment
				GSS	1045	—
				GSSS	SUS303	—

GEAR SHAPES : D

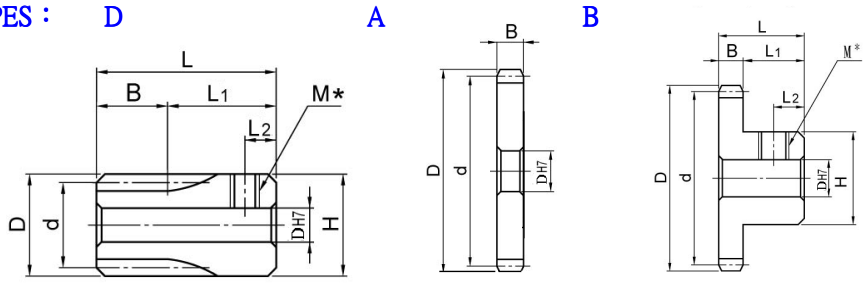

Catalog No.		Number of Teeth	Teeth Width Code B	Shapes	Bore Configuration Dh7			d	D	H	L	L1	L2	M
Type	Module				U	T	TG							
GSS GSSS	M0.8	12	7	A	4 5			9.6	11.2	11.2	20	13		
		14						11.2	12.8	12.8				
		15						12	13.6	13.6				
		16	5	A	4 5 6 6.35			12.8	14.4	10	14	3	M3	9
		18			7	7								
		20			7	7								
		24			7	7								
		25			7	7								
		28			7	7								
		30	5	B	5 6 6.35 8			14.4	16	12.5	14	4	M4	9
		32			7	7								
		36			7	7								
		40			7	7								
		45			7	7								
		48			7	7								
		50			7	7								
		50			7	7								

Order 訂貨代號

Catalog No. — Number of Teeth — Teeth Width Code B — Shapes — Bore Configuration

**GSSSM0.8 — 28 — 5 — B — T6**

PS1 : if you need another exceptional to process the specifications form, please contact us.

PS2 : Bore,Key Groove & Set Screw match,Please refer to 【Core & Kew Groove & Set Screw Design Form】 .



# Core & Key Groove & Set Screw Design Form

## Core&Key Groove Dimension Form

dH7	Key Groove Width bjs9		Depth	tolerance
8	3	±0.0125	1.4	+ 0.1 0
9				
10				
11	4	±0.015	1.8	
12				
13				
14	5	±0.015	2.3	
15				
16				
17				
18	6	±0.015	2.8	
19				
20				
21				
22	8	±0.018	3.3	+ 0.2 0
23				
24				
25				
26				
28				
29				
30				
31				
32				
33	10	±0.0215	3.8	
34				
35				
38				
40	12	±0.0215	3.8	
42				
43				
44				
45	14	±0.0215	3.8	
46				
47				
48				
50				
50				

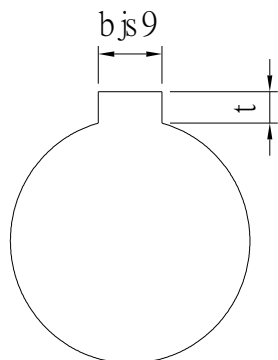

## Core&Set Screw Form

dH7	M
4	M3
5	
6	
6.35	
7	
8	M4
9	
10	
11	
12	M5
13	
14	
15	
16	
17	M6
18	
19	
20	
21	
22	
23	
24	
25	
26	
28	M8
29	
30	
31	
32	
33	
34	
35	
37	M10
38	
40	
42	
43	
44	
45	
46	
47	
48	
50	
52	
55	
57	
60	