

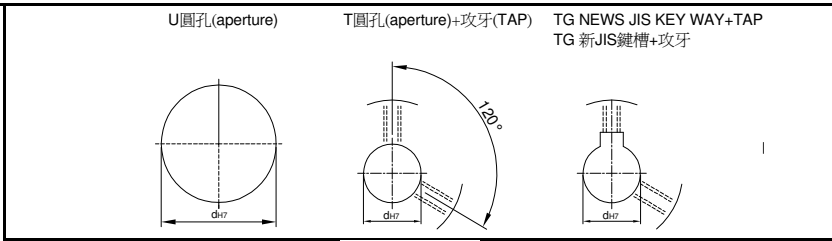

正齒輪 M1.5型

SPUR GEARS <M1.5>



TYPE	Material	Treatment
GSS	1045	—
GSSS	SUS303	—

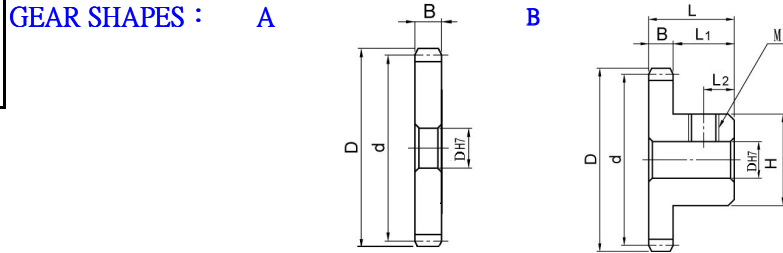

Catalog No.		Number of Teeth	Teeth Width Code B	Shapes	Bore Configuration Dh7				d	D	H	L	L1	L2	M
Type	Module				A		B								
					U孔	T孔	TG孔	U孔							
GSS GSSS	M1.5	15	10	A	6~14	6~12	8~12	6~12	22.5	25.5	18	29	9	4	M4
		16			24				27	20					
		18			27				30	22					
		20			30				33	25					
		24			36				39	30					
		25			37.5	40.5	30								
		26			39	42	32								
		28			42	45	34								
		30			45	48	35								
		32			48	51	35								
		35	52.5	55.5	40										
		36	54	57	40										
		40	60	63	45										
		48	72	75	50										
		50	75	78	50										
		52	78	81	50										
		60	90	93	55										
		70	105	108	65										
		80	120	123	65										

Order 訂貨代號 Catalog No. Number of Teeth Teeth Width Code B Shapes Bore Configuration

GSSSM1.5 30 15 B T15

PS1 : if you need another exceptional to process the specifications form, please contact us.
 PS2 : Bore,Key Groove & Set Screw match,Please refer to 【Core & Kew Groove & Set Screw Design Form】 .



Core & Key Groove & Set Screw Design Form

Core&Key Groove Dimension Form

dH7	Key Groove Width bjs9		Depth	tolerance
8	3	±0.0125	1.4	+ 0.1 0
9				
10				
11	4	±0.015	1.8	
12				
13				
14	5	±0.015	2.3	
15				
16				
17				
18	6	±0.015	2.8	
19				
20				
21				
22	8	±0.018	3.3	+ 0.2 0
23				
24				
25				
26				
28				
29				
30				
31				
32				
33	10	±0.0215	3.8	
34				
35				
38				
40	12	±0.0215	3.8	
42				
43				
44				
45	14	±0.0215	3.8	
46				
47				
48				
50				
50				

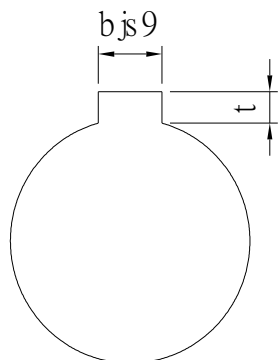

Core&Set Screw Form

dH7	M
4	M3
5	
6	
6.35	
7	
8	M4
9	
10	
11	
12	M5
13	
14	
15	
16	
17	M6
18	
19	
20	
21	
22	
23	
24	
25	
26	
28	M8
29	
30	
31	
32	
33	
34	
35	
37	M10
38	
40	
42	
43	
44	
45	
46	
47	
48	
50	
52	
55	
57	
60	