

## 鍊齒輪 SPROKET RS140

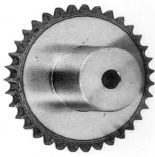

U圓孔(aperture)

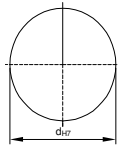

T圓孔(aperture)+攻牙(TAP)

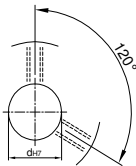

TG NEWS JIS KEY WAY+TAP  
TG 新JIS鍵槽+攻牙

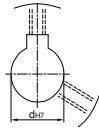

<b>TYPE</b>	<b>Material</b>
<b>SPS</b>	1045 tooth tip:induction hardening
<b>SPSS</b>	SUS303

SPROKETS SHAPES :

**A**

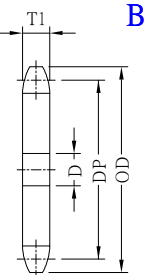

A TYPE

**B**

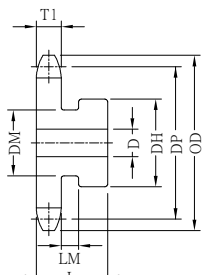

B TYPE

**BD**

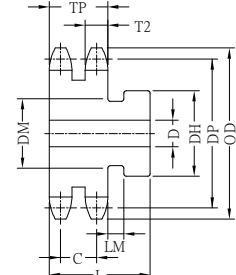

BD TYPE

**1 3/4" PITCH (44.45mm) T1=23.5 T2=22.7 TP =71.6 C=48.9**

TYPE	Catalog No.			A SHAPES		B SHAPES					BD型		DP	OD	
	Number of Teeth	Teeth Size	Shapes	Bore D	Compend Weight kg	Bore D		DH	DM	L	Compend Weight kg	Bore D			DH
						minimum	maximum								
SPS SPSS	9	RS140	A	1"		25	50	100	78	70				129.96	148
	10			2.88	25	66	110	98	70	4.66	30	92	143.84	163	
	11			3.49	25	73	125	112	70	5.59	30	106	157.78	178	
	12			4.15	25	80		125	70	6.74	30	121	171.74	193	
	13			4.84	30	80		140	70	7.43	30	135	185.74	207	
	14			5.62	30	89		140	70	9.30	30	150	199.76	221	
	15			6.45	30	89		140	70	10.1	30	164	213.79	236	
	16			7.34	30	89		140	70	11.0	30	178	227.84	250	
	17			8.29	30	89		140	70	12.0	30	193	241.97	264	
	18			9.30	30	89		140	70	13.0	30	207	255.98	279	
	19			10.3	33	95		140	70	15.5	30	221	270.06	293	
	20			11.5	33	95		140	70	16.6	30	235	284.15	307	
	21			12.7	33	95		137	70	17.8	30	250	298.24	322	
	22			13.8	38	95		137	70	18.9	30	264	312.24	336	
	23			15.2								30	278	326.44	350
	24		16.5	38	95		137	70	21.5	30	292	340.54	364		
	25		17.9	38	103		147	70	24.9	30	307	354.65	379		
	26		19.4	38	103		147	70	26.4		30	321	368.77	393	
	27		21.0									335	382.88	407	
	28		22.6									349	397.00	421	
	30		25.8	38	103		147	70	32.8			378	425.24	450	
	32		29.4	38	103		157	75	36.4			406	453.49	478	
	35		35.2	38	110		157	75	44.6			449	495.88	521	
	38		41.5	38	110		157	75	51.0			491	538.27	563	
	40		46.0	38	110		157	75	55.5			520	566.54	591	
	42		50.7	38	110		157	75	60.2			548	594.81	620	
	45		58.3	38	118				• 167	80	70.6	590	637.22	662	
	48		66.3	38	118				• 167	80	78.7	633	679.63	705	
	50		72.6	38	118				• 167	80	85.2	661	707.91	733	
	54			38	118				• 167	80	97.2	718	764.47	790	
60	104	38	118				• 167	80	118	803	849.32	875			

Order TYPE — Catalog No. — Bore configu-ration  
 訂貨代號 SPSS — 20RS140B — TG10

PS1 : if you need another exceptional to process the specifications form, please contact us.  
 PS2 : Bore,Key Groove & Set Screw match,Please refer to 【Core & Kew Groove & Set Screw Design Form】 .  
 PS3 : when Bore D over 50,please contact us that what size of <Key Groove & Set Screw> you need.



# Core & Key Groove & Set Screw Design Form

## Core&Key Groove Dimension Form

dH7	Key Groove Width bjs9		Depth	tolerance
8	3	±0.0125	1.4	+ 0.1 0
9				
10				
11	4	±0.015	1.8	
12				
13				
14	5	±0.015	2.3	
15				
16				
17				
18	6	±0.015	2.8	
19				
20				
21				
22	8	±0.018	3.3	+ 0.2 0
23				
24				
25				
26				
28				
29				
30				
31				
32				
33	10	±0.0215	3.8	
34				
35				
38				
40	12	±0.0215	3.8	
42				
43				
44				
45	14	±0.0215	3.8	
46				
47				
48				
50				
50				

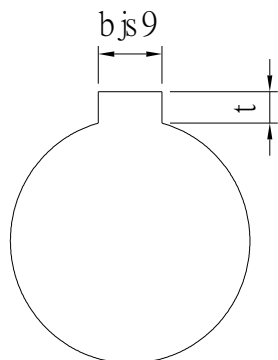

## Core&Set Screw Form

dH7	M
4	M3
5	
6	
6.35	
7	
8	M4
9	
10	
11	
12	M5
13	
14	
15	
16	
17	M6
18	
19	
20	
21	
22	
23	
24	
25	
26	
28	M8
29	
30	
31	
32	
33	
34	
35	
37	M10
38	
40	
42	
43	
44	
45	
46	
47	
48	
50	
52	
55	
57	
60	