

**時規皮帶輪 T5**  
**TIMING PULLEYS < T5 PULLEYS >**

**Tooth Shape :**

Type	Material	Treatment	Flange	Flange Treatment
PLAAA	A7075	Anodize	A6061	Anodize
PLAEA		Electroless nickel		Electroless nickel
PLS	1045	—	1045	—
PLSS	SUS303	—	A6061	Anodize

**Pulley Shapes :**

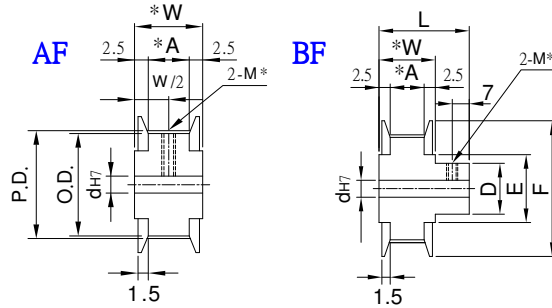

Type	Catalog No.			Bore configuration	Bore dh7				Bore W only (1mm Increment)		P.D.	O.D.	D	F	E	
	No.of teeth	Teeth Width Code	Pulley Shapes		U.T.TG Hole		W Hole		Z							J
					AF	BF	AF	BF	AF	BF						
PLAAA PLAEA PLS PLSS	12	T5012	AF	U	6~8	—	—	—	—	—	—	19.1	18.25	—	24	12
	14	A:12			6~10	6~8	—	—	—	—	—	—	22.28	21.45	14	26
	15	W:17	6~10		6~8	6~7	—	9~10	—	—	—	23.87	23.05	15	28	18
	16	L:28	7~12		7~10	7~9	—	10~12	—	—	—	25.46	24.6	17	32	20
	18		7~12		7~10	7~10	7~8	10~14	10~11	(AF)	2 ≤ J ≤ W-2	28.65	27.8	19	33	22
	20	T5017	7~16		7~10	7~12	7~8	10~15	10~11			31.83	31		36	24
	22	A:17	7~18		7~12	7~14	7~12	10~18	10~15	(BF)	2 ≤ J ≤ L-2	35.01	34.25	24	40	27
	24	W:22	7~20		7~13	7~16	7~14	10~20	10~18			38.2	37.4	27	45	30
	25	L:34	7~12		7~15	7~16	7~14	10~20	10~18	39.79	39	48	35			
	26		8~22		8~17	8~20	8~17	11~25	11~21	41.38	40.6			31		
	28	T5022	8~24		8~18	8~20	8~18	11~25	11~22	44.56	43.75	32	52	36		
	30	A:22	10~22		10~18	10~20	10~18	13~25	13~22	47.75	46.95	33	55	40		
	32	W:27	10~28		10~22	10~24	10~20	13~29	13~25	50.93	50.1	37	61	45		
	36	L:39	10~30		10~25	10~28	10~22	13~32	13~26	57.3	56.45	40	67	50		
	40		10~38		10~28	10~30	10~28	13~35	13~32	63.66	62.85	47	74	58		
	44	T5027	12~42		12~32	12~30	12~28	15~43	15~33	70.03	69.2	50	83	63		
	48	A:27	12~48		12~38	12~35	12~30	15~48	15~42	76.39	75.55	60	87	67		
	50	W:32	12~50		12~40	12~35	12~30	15~50	15~45	79.58	78.75	63	99	80		
	60	L:44	12~60		12~40	12~38	12~35	15~60	15~55	95.49	94.65	75				

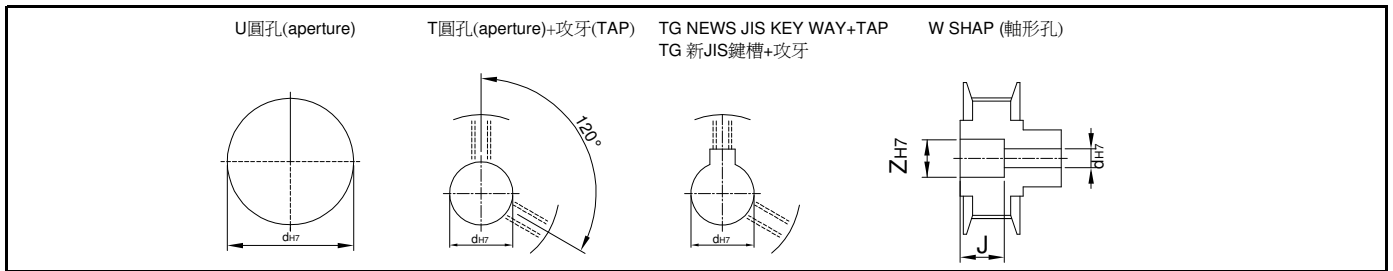

**Order**    TYPE    —    Catalog No.    —    Bore configuration

**訂貨代號**    **PLAA**    —    **20T5017BF**    —    **T10**

PS1 : if you need another exceptional to process the specifications form, please contact us.  
PS2 : Bore,Key Groove & Set Screw match,Please refer to **【Core & Kew Groove & Set Screw Design Form】** .



# Core & Key Groove & Set Screw Design Form

## Core&Key Groove Dimension Form

dH7	Key Groove Width bjs9		Depth	tolerance
8	3	±0.0125	1.4	+ 0.1 0
9				
10				
11	4	±0.015	1.8	
12				
13				
14	5	±0.015	2.3	
15				
16				
17				
18	6	±0.015	2.8	
19				
20				
21				
22	8	±0.018	3.3	+ 0.2 0
23				
24				
25				
26				
28				
29				
30				
31				
32				
33	10	±0.0215	3.8	
34				
35				
38				
40	12	±0.0215	3.8	
42				
43				
44				
45	14	±0.0215	3.8	
46				
47				
48				
50				
50				

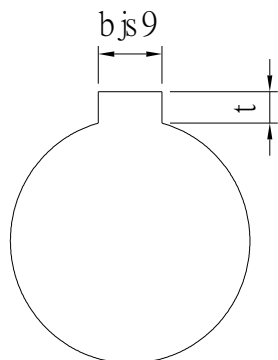

## Core&Set Screw Form

dH7	M
4	M3
5	
6	
6.35	
7	
8	M4
9	
10	
11	
12	M5
13	
14	
15	
16	
17	M6
18	
19	
20	
21	
22	
23	
24	
25	
26	
28	M8
29	
30	
31	
32	
33	
34	
35	
37	M10
38	
40	
42	
43	
44	
45	
46	
47	
48	
50	
52	
55	
57	
60	